

FIXIT



Today's Service Station

The Fixit includes all the tools necessary to perform basic bike repairs and maintenance, from changing a flat to adjusting brakes and derailleurs. The tools and air pump are securely attached to the stand with stainless steel cables and tamper-proof fasteners. Hanging the bike from the hanger arms allows the pedals and wheels to spin freely while making adjustments.

Patent D680,9145



DERO
A PLAYCORE Company

Hanger arms accommodate most types of bikes

QR code takes smart phone users to comprehensive bike repair web site

Large surface area for sponsorship, branding, or way-finding signage

Tools are secured with braided stainless steel aircraft cables

Pump hose is reinforced for maximum protection

Pump holster can be mounted on either side or back of Fixit

Hanger and pump (shipped as 2nd package) pack inside main body for easy, inexpensive shipping

Hanger arms can be mounted at 12, 3, 6, or 9 o'clock

Hanger is ADA compliant

Includes most commonly used tools for simple bike maintenance

Screwdrivers and Allen Wrenches are on swivel connectors for easier use

Pump head accommodates Presta and Schrader valve stem types

Tools included:
 Philips and flat head screwdrivers
 2.5, 3, 4, 5, 6, 8mm Allen wrenches
 Headset wrench
 Pedal wrench
 8, 9, 10, 11mm box wrenches
 Tire levers (2)

FINISH OPTIONS

Galvanized



Stainless



Powder Coat

White	Black	Light Gray RAL 7042	Deep Red RAL 3003	Yellow RAL 1023
CNH Bright Yellow	Orange RAL 2004	Beige RAL 1001	Iron Gray RAL 7011	Hunter Green RAL 6005
Light Green RAL 6018	Green RAL 6016	Sepia Brown RAL 8014	Bronze	Silver 9007
Dark Purple	Flat Black	Wine Red RAL 3005		

Thermoplastic

Black	Green	Red	Gray	Brown
-------	-------	-----	------	-------



FIXIT

Submittal Sheet

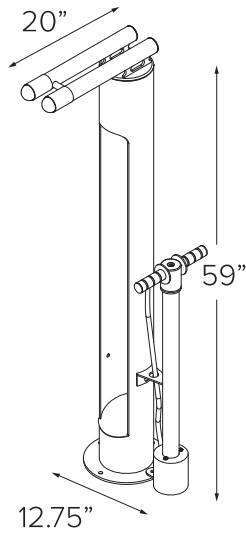

Fixit with Air Kit 2

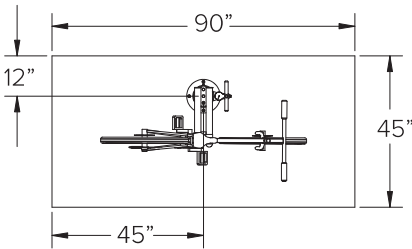

Minimum Footprint

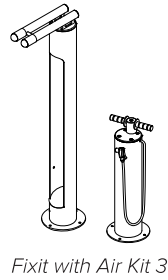

Fixit with Air Kit 3

CAPACITY

1 Bike

MATERIALS

Main body: 6"x .154" tube
 Bike Hanger: 1.5" sch. 40 pipe, 1/4" plate
 Foot: 10" dia. x .25" plate
 Tool tethers: 5/32" stainless steel cable
 Manual air pump

Hand tools:

- Philips and flat head screwdrivers
- 2.5, 3, 4, 5, 6, 8mm Allen wrenches
- Headset wrench
- Pedal wrench
- 8, 9, 10, 11mm box wrenches
- Tire levers (2)

FINISHES

- Galvanized**
An after fabrication hot dipped galvanized finish is our standard option.
- Powder Coat**
Our powder coat finish assures a high level of adhesion and durability by following these steps:
 1. Sandblast
 2. Epoxy primer electrostatically applied
 3. Final thick TGIC polyester powder coat
- Thermoplastic**
In addition to an increased thickness (8-10mils), the thermoplastic finish covers a galvanized layer and offers superior impact resistance over powder coating.
- Stainless**
Stainless Steel: 304 grade stainless steel material finished in either a high polished shine or a satin finish.

MOUNT OPTIONS

- In-ground**
Is embedded into concrete base.
- Surface**
Has 10" diameter x.25" foot with four anchors per foot.



DERO
A PLAYCORE Company

www.dero.com | 1-888-337-6729