

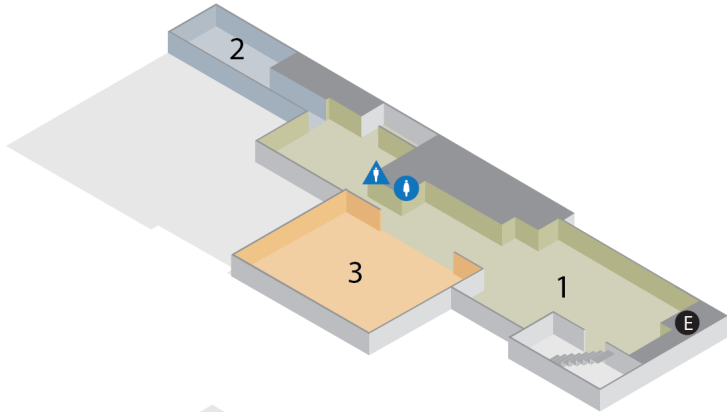



- # 5
- Art & Music Department
- ① Nonfiction 700-799  
Reference  
Music CDs
  - ② Vinyl Records
  - ⓔ Elevator
- Restrooms   



- # 4
- Children's Library
- ① Children's Fiction & Picture Books
  - ② Story Room
  - ③ Children's Nonfiction & Young Teen
  - ⓔ Elevator
- Restrooms for Children   

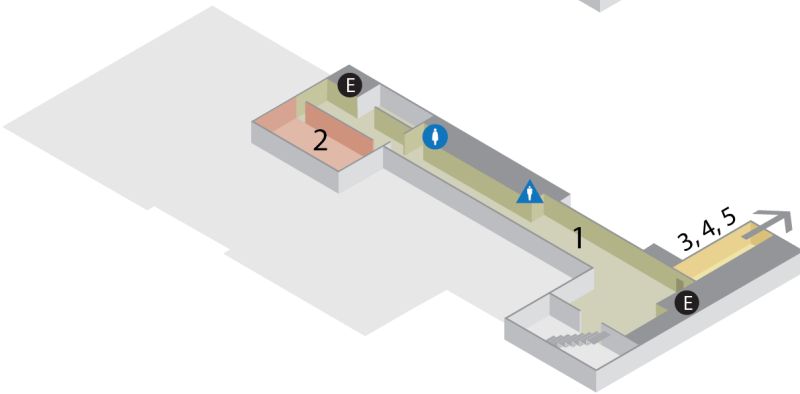

- # 3
- ① Magazines & Newspapers
  - ② Electronic Classroom
  - ③ Community Meeting Room
  - ④ Library Administration
  - ⑤ Library Foundation
  - ⓔ Elevator
- Restrooms   

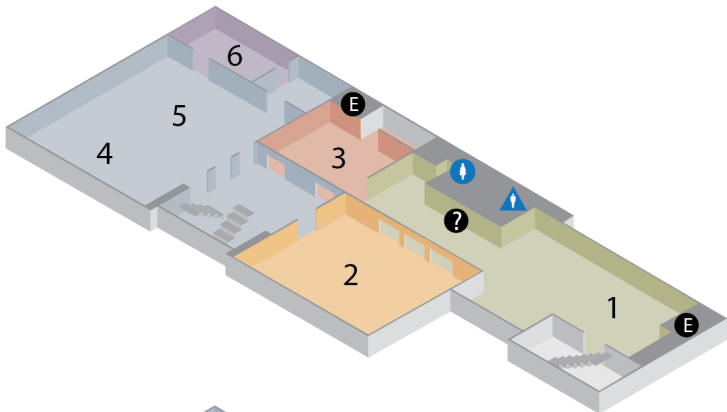

- # 2
- Ⓡ Reference Desk
  - ① Public Computers
  - ② Reference Books
  - ③ Teen
  - ④ International Languages
  - ⑤ Nonfiction 900-999
  - ⑥ Berkeley History Room
  - ⓔ Elevator
- Restrooms   

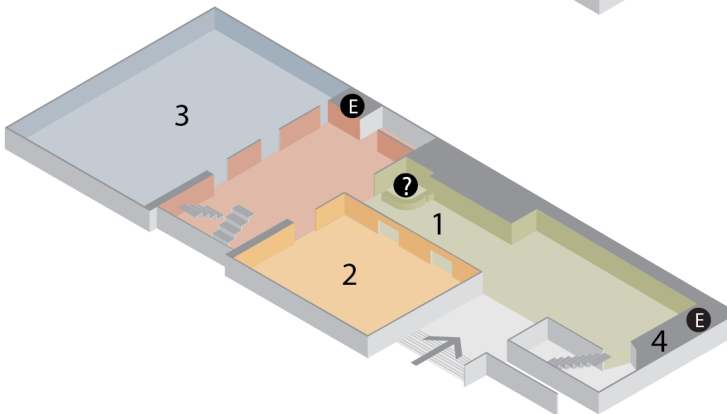

- # 1
- Ⓡ Information Desk
  - ① Check Out, Audiobooks, DVDs and Graphic Novels
  - ② Fiction  
Science Fiction / Mysteries
  - ③ Nonfiction  
000-699, 800-899  
Large Print Books
  - ④ Friends' Bookstore
  - ⓔ Elevator
- Restrooms on floors 2, 3 & 5

**Branch Libraries**

Mon – Tues: 10 – 6

Wed – Thu: 12 – 8

Fri – Sat: 10 – 6

**Claremont Branch**

**(510) 981-6280**

2940 Benvenue Ave. at Ashby

Berkeley, CA 94705

**North Branch**

**(510) 981-6250**

1170 The Alameda at Hopkins

Berkeley, CA 94707

**South Branch**

**(510) 981-6260**

1901 Russell St. at MLK

Berkeley, CA 94703

**West Branch**

**(510) 981-6270**

1125 University Ave. at San Pablo

Berkeley, CA 94702

**Tool Lending Library**

**(510) 981-6101**

1901 Russell St. at MLK

Berkeley, CA 94703

Tues: 10 – 6:00

Wed – Thu: 12 – 8:00

Fri: 1 – 6:00

Sat: 10 – 6:00

Sun – Mon: Closed

**Berkeley Reads Adult Literacy**

**(510) 981-6299**

1125 University Ave. at San Pablo

Berkeley, CA 94702

Mon – Tues: 10 – 6

Wed – Thu: 12 – 8

Fri: 10 – 6

**Central Library**

**(510) 981- 6100**

2090 Kittredge at Shattuck

Berkeley, CA 94704

Mon: 12 – 8

Tues: 10 – 8

Wed – Sat: 10 – 6

Sun: 1 – 5

Children’s (510) 981- 6223

Reference (510) 981- 6148

Renewals (510) 981- 6249

Administration (510) 981- 6195

Art and Music (510) 981- 6241

Volunteers (510) 981- 6146

Outreach services for Berkeley residents who cannot get to the Library due to extended illness or disability

(510) 981- 6160

Extended Services (longer loan periods for disabled Library users)

(510) 981- 6100

For information on temporary branch library closures for construction, please go to [berkeleypubliclibrary.org/branchimprovements](http://berkeleypubliclibrary.org/branchimprovements)

berkeleypubliclibrary.org

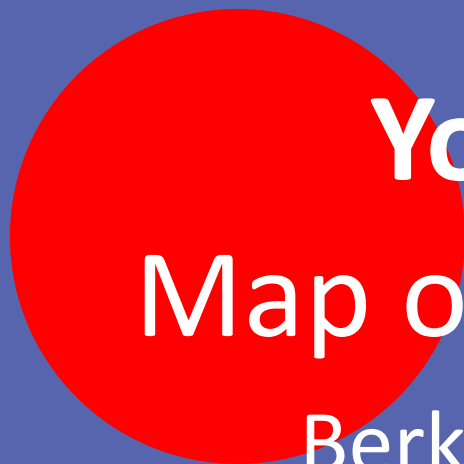

**You Are Here**

**Map of Central Library**

**Berkeley Public Library**